



## 瓷介電容器



## Ceramic Capacitors

### □用途

該產品主要用於彩電、電腦顯示器、影印機、節能燈等的電源電路、行輸出電路等部分。

### □Application

Using for H-out and supply circuits of color TV and monitor、copy machine、inverter lighting.

### □規格型號(Specification Type)

品名 CODE NO.	Dmax (mm)	Tmax (mm)	F±1.5 (mm)	d±10% (mm)	Coat. Ext. (mm) max	Lead Length (mm) min	Lead Shape
CT81-10KV-08b-2D4-101*	8	8	10	0.56	3.5	25	b
CT81-10KV-10b-2D4-221*	10	8	10	0.8	3.5	25	b
CT81-10KV-11b-2D4-331*	11	7	10	0.8	3.5	25	b
CT81-10KV-14b-2D4-471*	14	7	10	0.8	3.5	25	b
CT81-10KV-15b-2D4-501*	15	8	10	0.8	3.5	25	b
CT81-10KV-15b-2D4-681*	15	7	10	0.8	3.5	25	b
CT81-10KV-19b-2D4-102*	19	8	10/13	0.8	3.5	25	b
CT81-12KV-08b-2D4-101*	8	8	10	0.56	3.5	25	b
CT81-12KV-10b-2D4-221*	10	8	10	0.8	3.5	25	b
CT81-12KV-11b-2D4-331*	11	7	10	0.8	3.5	25	b
CT81-12KV-14b-2D4-471*	14	7	10	0.8	3.5	25	b
CT81-12KV-15b-2D4-501*	15	8	10	0.8	3.5	25	b
CT81-12KV-15b-2D4-681*	15	7	10	0.8	3.5	25	b
CT81-12KV-19b-2D4-102*	19	8	10/13	0.8	3.5	25	b
CT81-15KV-08b-2D4-101*	8	9	10	0.8	3.5	25	b
CT81-15KV-10b-2D4-221*	10	8	10	0.8	3.5	25	b
CT81-15KV-11b-2D4-331*	11	7	10	0.8	3.5	25	b
CT81-15KV-14b-2D4-471*	14	7	10	0.8	3.5	25	b
CT81-15KV-15b-2D4-501*	15	8	10	0.8	3.5	25	b
CT81-15KV-15b-2D4-681*	15	8	10	0.8	3.5	25	b
CT81-15KV-19b-2D4-102*	19	8	10/13	0.8	3.5	25	b
CT81-20KV-08b-2D4-101*	8	9	10	0.8	3.5	25	b
CT81-20KV-12b-2D4-221*	12	10	10	0.8	3.5	25	b
CT81-20KV-13b-2D4-331*	13	9	10	0.8	3.5	25	b
CT81-20KV-16b-2D4-471*	16	9	10	0.8	3.5	25	b
CT81-20KV-18b-2D4-501*	18	11	10	0.8	3.5	25	b
CT81-20KV-19b-2D4-751*	19	10	10	0.8	3.5	25	b
CT81-20KV-24b-2D4-102*	24	11	10/13	0.8	3.5	25	b
CT81-25KV-09b-2D4-101*	9	10	10	0.8	3.5	25	b
CT81-25KV-12b-2D4-221*	12	10	10	0.8	3.5	25	b
CT81-25KV-16b-2D4-471*	16	9	10	0.8	3.5	25	b
CT81-25KV-18b-2D4-501*	18	11	10	0.8	3.5	25	b



品名 CODE NO.	Dmax (mm)	Tmax (mm)	F±1.5 (mm)	d±10% (mm)	Coat. Ext. (mm) max	Lead Length (mm) min	Lead Shape
CT81-10KV-08b-ZM-101*	8	8	10	0.56	3.5	25	b
CT81-10KV-10b-ZM-221K	10	8	10	0.8	3.5	25	b
CT81-10KV-10b-ZM-251M	10	8	10	0.8	3.5	25	b
CT81-10KV-11b-ZM-331K	11	7	10	0.8	3.5	25	b
CT81-10KV-14b-ZM-471K	14	7	10	0.8	3.5	25	b
CT81-10KV-15b-ZM-501*	15	8	10	0.8	3.5	25	b
CT81-10KV-15b-ZM-681K	15	7	10	0.8	3.5	25	b
CT81-10KV-19b-ZM-102K	19	8	10/13	0.8	3.5	25	b
CT81-12KV-08b-ZM-101*	8	8	10	0.56	3.5	25	b
CT81-12KV-10b-ZM-221*	10	8	10	0.8	3.5	25	b
CT81-12KV-11b-ZM-331*	11	7	10	0.8	3.5	25	b
CT81-12KV-14b-ZM-471*	14	7	10	0.8	3.5	25	b
CT81-12KV-15b-ZM-501*	15	8	10	0.8	3.5	25	b
CT81-12KV-15b-ZM-681*	15	7	10	0.8	3.5	25	b
CT81-12KV-19b-ZM-102K	19	8	10/13	0.8	3.5	25	b
CT81-15KV-08b-ZM-101*	8	9	10	0.8	3.5	25	b
CT81-15KV-10b-ZM-221*	10	8	10	0.8	3.5	25	b
CT81-15KV-11b-ZM-331*	11	7	10	0.8	3.5	25	b
CT81-15KV-14b-ZM-471*	14	7	10	0.8	3.5	25	b
CT81-15KV-15b-ZM-501*	15	8	10	0.8	3.5	25	b
CT81-15KV-15b-ZM-681*	15	8	10	0.8	3.5	25	b
CT81-15KV-19b-ZM-102*	19	8	10/13	0.8	3.5	25	b
CT81-20KV-08b-ZM-101*	8	9	10	0.8	3.5	25	b
CT81-20KV-12b-ZM-221*	12	10	10	0.8	3.5	25	b
CT81-20KV-13b-ZM-331*	13	9	10	0.8	3.5	25	b
CT81-20KV-16b-ZM-471*	16	9	10	0.8	3.5	25	b
CT81-20KV-18b-ZM-501*	18	11	10	0.8	3.5	25	b
CT81-20KV-19b-ZM-751*	19	10	10	0.8	3.5	25	b
CT81-20KV-24b-ZM-102*	24	11	13	0.8	3.5	25	b
CT81-25KV-09b-ZM-101*	9	10	10	0.8	3.5	25	b
CT81-25KV-12b-ZM-221*	12	10	10	0.8	3.5	25	b
CT81-25KV-16b-ZM-471*	16	9	10	0.8	3.5	25	b
CT81-25KV-18b-ZM-501*	18	11	10	0.8	3.5	25	b
CT81-25KV-24b-ZM-102*	24	11	10	0.8	3.5	25	b
CT81-30KV-13b-ZM-221*	13	11	10	0.8	3.5	25	b
CT81-30KV-16b-ZM-471*	16	9	10	0.8	3.5	25	b
CT81-30KV-18b-ZM-501*	18	11	10	0.8	3.5	25	b
CT81-30KV-19b-ZM-751*	19	11	10	0.8	3.5	25	b
CT81-30KV-24b-ZM-102*	24	11	10	0.8	3.5	25	b

品名 CODE NO.	Dmax (mm)	Tmax (mm)	F±1.5 (mm)	d±10% (mm)	Coat. Ext. (mm) max	Lead Length (mm) min	Lead Shape
CT81-10KV-11b-2B4-331*	11	10	10	0.8	3.5	25	b
CT81-10KV-12b-2B4-471*	12	9	10	0.8	3.5	25	b
CT81-10KV-14b-2B4-561*	14	10	10	0.8	3.5	25	b
CT81-10KV-16b-2B4-681*	16	11	10	0.8	3.5	25	b
CT81-10KV-17b-2B4-102*	17	9	10	0.8	3.5	25	b
CT81-12KV-11b-2B4-331*	11	10	10	0.8	3.5	25	b
CT81-12KV-12b-2B4-471*	12	9	10	0.8	3.5	25	b
CT81-12KV-14b-2B4-561*	14	10	10	0.8	3.5	25	b
CT81-12KV-16b-2B4-681*	16	11	10	0.8	3.5	25	b
CT81-12KV-17b-2B4-102*	17	9	10	0.8	3.5	25	b
CT81-15KV-11b-2B4-101M	11	9	10	0.8	3.5	25	b
CT81-15KV-08b-2B4-151*	8	10	10	0.8	3.5	25	b
CT81-15KV-11b-2B4-331*	11	10	10	0.8	3.5	25	b
CT81-15KV-12b-2B4-471*	12	9	10	0.8	3.5	25	b
CT81-15KV-14b-2B4-561*	14	10	10	0.8	3.5	25	b
CT81-15KV-16b-2B4-681*	16	11	10	0.8	3.5	25	b
CT81-15KV-18b-2B4-102M	18	10	10	0.8	3.5	25	b
CT81-15KV-19b-2B4-152*	19	10	10	0.8	3.5	25	b
CT81-15KV-24b-2B4-222*	24	10	10	0.8	3.5	25	b
CT81-15KV-24b-2B4-252*	24	10	10	0.8	3.5	25	b
CT81-20KV-14b-2B4-471*	14	12	10	0.8	3.5	25	b
CT81-20KV-15b-2B4-561*	15	12	10	0.8	3.5	25	b
CT81-20KV-16b-2B4-681*	16	11	10	0.8	3.5	25	b
CT81-20KV-19b-2B4-102*	19	12	10	0.8	3.5	25	b
CT81-20KV-24b-2B4-152*	24	13	10	0.8	3.5	25	b
CT81-25KV-14b-2B4-471*	14	12	10	0.8	3.5	25	b
CT81-25KV-15b-2B4-561*	15	12	10	0.8	3.5	25	b
CT81-25KV-16b-2B4-681*	16	11	10	0.8	3.5	25	b
CT81-25KV-19b-2B4-102*	19	12	10	0.8	3.5	25	b
CT81-30KV-14b-2B4-471*	14	12	10	0.8	3.5	25	b
CT81-30KV-16b-2B4-681*	16	11	10	0.8	3.5	25	b
CT81-30KV-24b-2B4-102*	24	15	10	0.8	3.5	25	b

品名 CODE NO.	Dmax (mm)	Tmax (mm)	F±1.5 (mm)	d±10% (mm)	Coat. Ext. (mm) max	Lead Length (mm) min	Lead Shape
CT81-10KV-12b-2E4-102M	12	10	10	0.8	3.5	25	b
CT81-10KV-14b-2E4-152M	14	10	10	0.8	3.5	25	b
CT81-10KV-17b-2E4-222M	17	10	10	0.8	3.5	25	b
CT81-10KV-17b-2E4-252M	17	9	10	0.8	3.5	25	b
CT81-10KV-18b-2E4-332M	18	10	10	0.8	3.5	25	b
CT81-10KV-19b-2E4-472M	19	9	10	0.8	3.5	25	b
CT81-12KV-12b-2E4-102M	12	10	10	0.8	3.5	25	b
CT81-12KV-14b-2E4-152M	14	10	10	0.8	3.5	25	b
CT81-12KV-17b-2E4-222M	17	10	10	0.8	3.5	25	b
CT81-12KV-19b-2E4-332M	19	10	10	0.8	3.5	25	b
CT81-12KV-19b-2E4-472M	19	9	10	0.8	3.5	25	b
CT81-15KV-12b-2E4-102M	12	10	10	0.8	3.5	25	b
CT81-15KV-14b-2E4-152M	14	10	10	0.8	3.5	25	b
CT81-15KV-17b-2E4-222M	17	10	10	0.8	3.5	25	b
CT81-15KV-19b-2E4-332M	19	10	10	0.8	3.5	25	b
CT81-20KV-10b-2E4-511M	10	11	10	0.8	3.5	25	b
CT81-20KV-14b-2E4-102M	14	11	10	0.8	3.5	25	b
CT81-20KV-15b-2E4-152M	15	11	10	0.8	3.5	25	b
CT81-20KV-18b-2E4-222M	18	11	10	0.8	3.5	25	b
CT81-20KV-23b-2E4-332M	23	12	10	0.8	3.5	25	b
CT81-20KV-24b-2E4-472M	24	11	10	0.8	3.5	25	b
CT81-25KV-14b-2E4-102M	14	11	10	0.8	3.5	25	b
CT81-25KV-15b-2E4-152M	15	11	10	0.8	3.5	25	b
CT81-30KV-16b-2E4-102M	16	13	10	0.8	3.5	25	b
CT81-30KV-24b-2E4-222M	24	15	19	0.8	3.5	25	b

品名 CODE NO.	Dmax (mm)	Tmax (mm)	F±1.5 (mm)	d±10% (mm)	Coat. Ext. (mm)max	Lead Length (mm)min	Lead Shape
CC81-10KV-08b-SL-3*	8	8	10	0.56	3.5	25	b
CC81-10KV-08b-SL-5*	8	8	10	0.56	3.5	25	b
CC81-10KV-08b-SL-10*	8	7	10	0.56	3.5	25	b
CC81-10KV-09b-SL-22*	9	7	10	0.56	3.5	25	b
CC81-10KV-10b-SL-39*	10	7	10	0.56	3.5	25	b
CC81-10KV-12b-SL-47*	12	7	10	0.8	3.5	25	b
CC81-10KV-14b-SL-62*	14	7	10	0.8	3.5	25	b
CC81-10KV-16b-SL-101*	16	7	10	0.8	3.5	25	b
CC81-12KV-08b-SL-5*	8	8	10	0.8	3.5	25	b
CC81-12KV-08b-SL-10*	8	7	10	0.8	3.5	25	b
CC81-12KV-09b-SL-22*	9	7	10	0.8	3.5	25	b
CC81-12KV-10b-SL-33*	10	7	10	0.8	3.5	25	b
CC81-12KV-11b-SL-39*	11	7	10	0.8	3.5	25	b
CC81-12KV-12b-SL-47*	12	7	10	0.8	3.5	25	b
CC81-12KV-16b-SL-101*	16	7	10	0.8	3.5	25	b
CC81-15KV-08b-SL-5*	8	8	10	0.8	3.5	25	b
CC81-15KV-08b-SL-10*	8	7	10	0.8	3.5	25	b
CC81-15KV-10b-SL-22*	10	7	10	0.8	3.5	25	b
CC81-15KV-10b-SL-33*	10	7	10	0.8	3.5	25	b
CC81-15KV-11b-SL-39*	11	7	10	0.8	3.5	25	b
CC81-15KV-12b-SL-47*	12	7	10	0.8	3.5	25	b
CC81-15KV-16b-SL-101*	16	7	10	0.8	3.5	25	b
CC81-20KV-10b-SL-10*	10	9	10	0.8	3.5	25	b
CC81-20KV-10b-SL-22*	10	7	10	0.8	3.5	25	b
CC81-30KV-11b-SL-25*	11	10	10	0.8	3.5	25	b
CC81-30KV-19b-SL-101*	19	9	10	0.8	3.5	25	b

注：“\*”表示根據客戶要求(Note: “\*” according to customer requirements)

□ 標識方法 (Marking)

	① 公司代號 Manufacturer's Code
	② 溫度特性 Temperature Characteristic
	③ 額定電壓 Rated Voltage
	④ 標稱容量 Rated Capacitance
	⑤ 容量偏差 Tolerance of Capacitance

□ 引線形式 Lead Shape

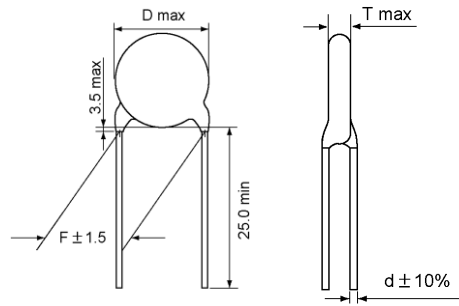

b 式 (Type b)

□結構(Structure)

包封层  
Coating  
介質  
Dielectric  
電極  
Electrode  
焊料  
Solder  
引線  
Lead wire

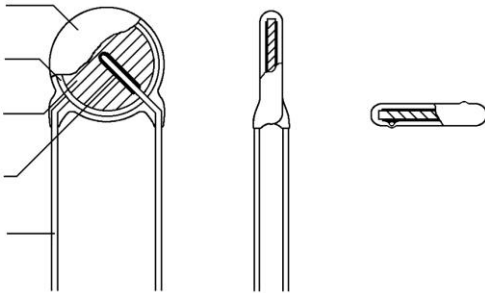

包封層(Coating) : 環氧樹脂(Epoxy Resin)

介質(Dielectric): 陶 瓷 (Ceramic)

電極(Electrode : 銀 (Silver)

焊料(Solder) : 錫(Alloy Tin)

引線(Lead Wire) : 鍍錫引出線(Lead)

□主要材料(Main Material)

序號 NO.	材料名稱(Material name)	規格(Specifications)
1	介質 Ceramic core	CT81 DC CC81 DC
2	電極 Silver paste	SP-255PL SP-YD55
3	包封料 Expoxy powder coating	HXF-240 XCP-231 EF-150
4	銅線 Tin-plated copper weld Steel wire	0.8
5	無鉛焊料 Unleaded solder	97%Sn 2.5%Ag 0.5%Cu

□室內條件(Room Condition)

溫度(Temp.) : 15~35℃ 濕度(R. H.) : 45~75%  
氣壓(Atm pressure) : 86~106kPa (860~1060mbar)

□測試條件(Test Condition)

溫度(Temp.) : 25±2℃ 濕度(R. H.) : 50~60%  
電壓(Vol.) : 1.0±0.2Vrms 頻率(Freq.) : 1±0.2KHz (SL: 1±0.2MHz)



□容量—溫度變化曲線 Cap.—Temp. Curve

2B4 (Y5P)

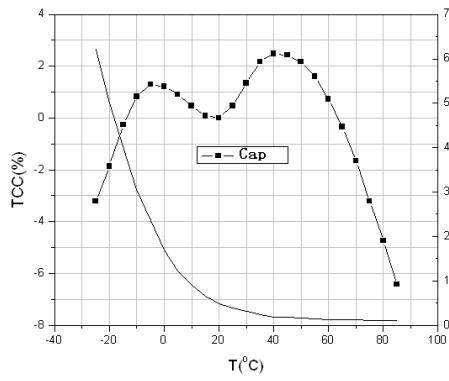

2E4 (Y5U)

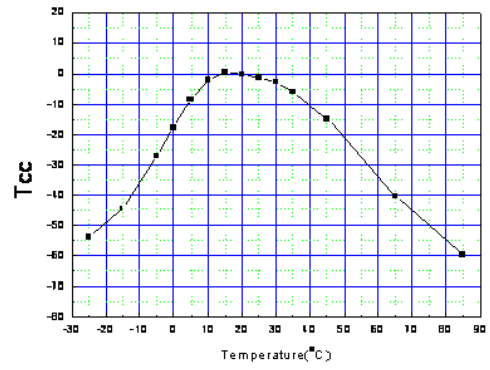

2D4 (Y5T)

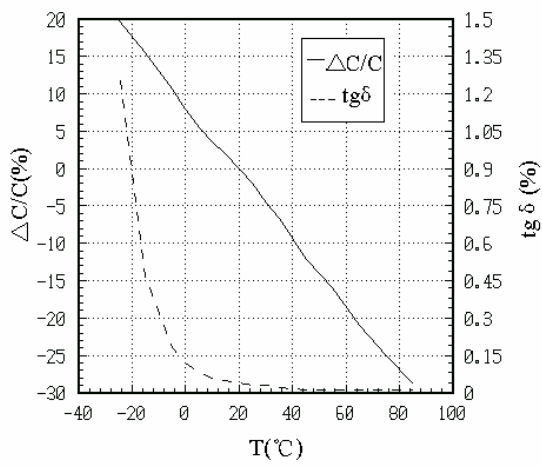

SL

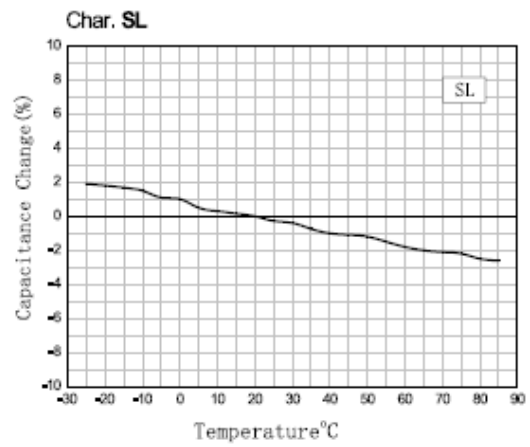

ZM

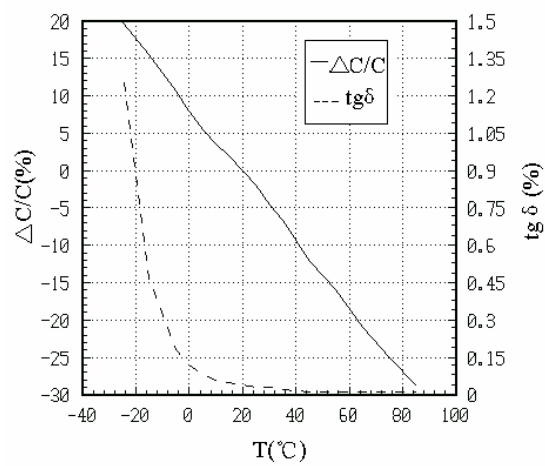

□ 型號命名方法 Part Code Designation

CT81 — 15KV — 18 b — 2B4 — 102 K

①                      ②                      ③ ④                      ⑤                      ⑥ ⑦

① 種類 Class

代碼 Code	種類 Class
CC81	I 類高壓 Class I High-Voltage
CT81	II 類高壓 Class II High-Voltage

⑤ 溫度特性 Temperature Characteristic

代碼 Code	容量變化 Cap. Change
2B4	-10~+10%
2E4	-56~+22%
2D4	-30~+20%
ZM	-4700±1000ppm/°C
SL	+350~-1000ppm/°C

② 額定電壓 Rated Voltage

代碼 Code	額定電壓 Rated Vol.	代碼 Code	額定電壓 Rated Vol.
10KV	10000V. DCVrms	25KV	25000V. DCVrms
12KV	12000V. DCVrms	30KV	30000V. DCVrms
15KV	15000V. DCVrms		
20KV	20000V. DCVrms		

⑥ 標稱容量 Rated Capacitance

代碼 Code	靜電容量 Capacitance	代碼 Code	靜電容量 Capacitance
102	1000pF	332	3300pF
152	1500pF	472	4700pF
222	2200pF		

③ 主體外徑 Body Diameter

代碼 Code	Dmax (mm)	代碼 Code	Dmax (mm)
08	8.0mm	10	10.0mm
09	9.0mm	11	11.0mm
以此類推 And so on			

⑦ 容量允差 Tolerance

代碼 Code	容量允差 Tolerance
K	±10%
M	±20%

④ 引線形式 Lead Shape

代碼 Code	形式 Shape
b	直腳 Straight

□包裝 (packing)

1、包裝數量 (packing quantity):

成型方式 Molding mode	袋裝數量 (只) Quantity per bag (pcs)	內包裝袋數量 (只) Quantity internal packing boxes (pcs)	外包裝箱數量 (只) Quantity internal packing boxes (pcs)
b	50~200/3#	250~1000	500~2000
備註：五個3號袋裝入一個1號袋 Five 3 bags into a no. 1 bag			

2、包裝標識 (packing marking):

示例(Example)	項目( Item )	
		公司商標 (Manufacturer's Marking)
	物料編碼 Code	用戶要求時 When the customer require
	規格型號 Model	詳見如上表格，(Please see the detail in the upper sheet)
	生產批號 Product lots	生產批號 Product lots
	生產日期 Productive date	產品生產時間 The produce time of the product
	成型代號 lead shape	用戶要求時 When the customer require
	數量 Quantity	每袋的包裝數量 The packing quantity per plastic bag

3、外包裝 (over-wrap packing):

裝箱數量應為 100、500 的整數倍。(The packing quantity should be integral multiple of 100 or 500)

採用瓦楞紙箱包裝，裝箱不滿時用空箱填充。(The corrugated box packaging, Each box 10 boxes of Taping products, packing dissatisfaction with empty container filling )。